

4.2. Machine Placement

For an effective machine, the position and the base of the machine are important. The machine must be placed on a flat, preferably cement base. The most important point to be careful is to place the machine very accurately with precise parallelism.

Ask for the help of an experienced and qualified technician while setting up the machine. Allow sufficient space around the machine to enable the operator to safely bring work pieces to and from the table, without risk or injury to himself or any third party in vicinity.

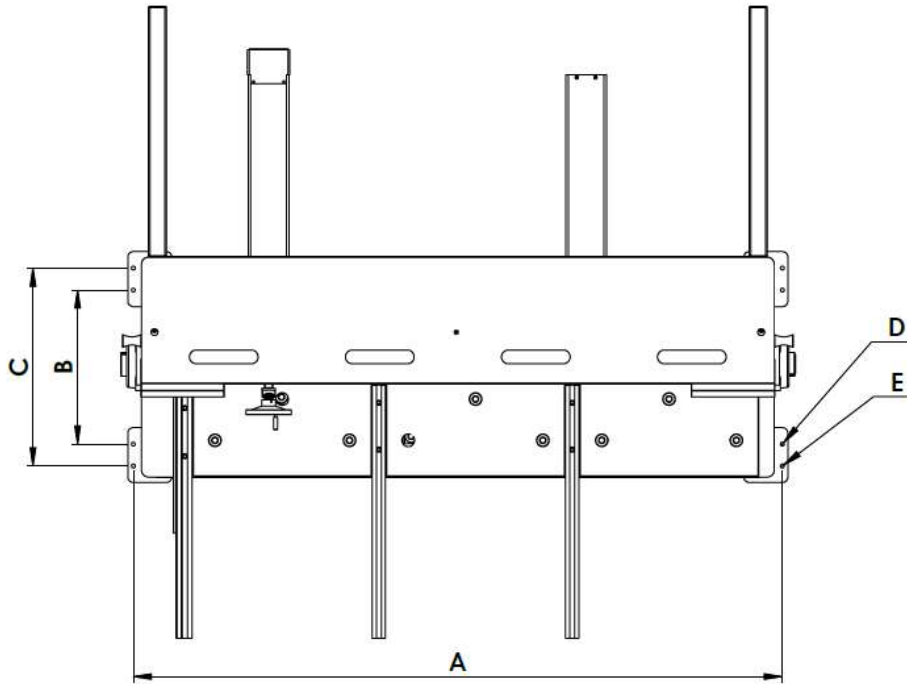

MODEL	A	B	C	D	E
RGMS 1350-3	1663	560	720	Ø13,5	Ø14
RGMS 1550-3	2163	560	720	Ø13,5	Ø14
RGMS 2050-3	2663	560	720	Ø13,5	Ø14

- You can fix your machine to the ground through the holes marked 'D' as shown in the picture.

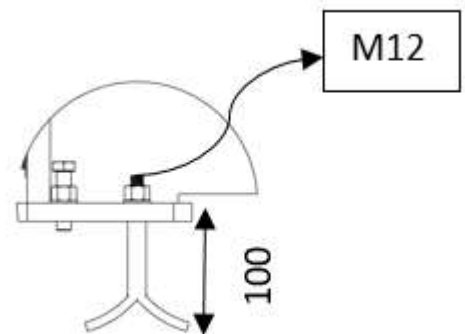

4.3. Machine Working Area

The material to be processed is loaded only from the front of the machine.
There must be sufficient space for operator operation, material transport, adjustment and maintenance work.

Attention : During the functioning the machine or functioning of the piston by an operator, never load material on the machine.

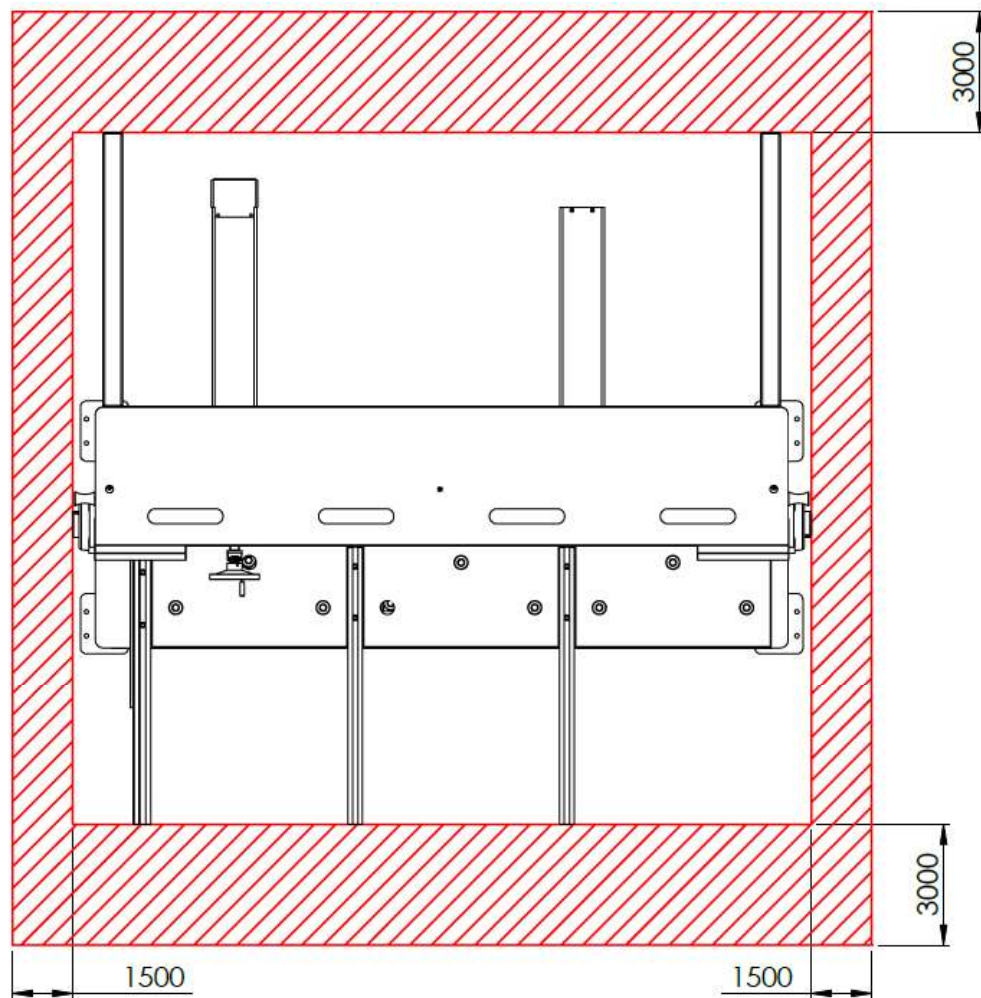

Not: All dimensions in mm.